



Postpost 三里屯太古里售货亭方案



Proposal for Postpost Kiosk @ Taikoo Li Sanlitun



by 切线 Tangent Essays

01





基于现状结构的轻质改造策略

Lightweight Adaptive Strategy Based on Existing Structure

基于现状售货亭的钢结构基础，方案在顶部以新增的伞状钢龙骨结构与其焊接，并覆以具15%透明度的膜材。在为广场上的游人提供尽可能慷慨的遮阴避雨的空间同时，最大程度利用现有结构并减轻新增结构的重量。出檐范围控制在现亭子主体2米范围内，形成具有场所感的休憩空间。

Based on the existing steel structure foundation of the kiosk, the design proposes welding a newly added umbrella-shaped steel frame to its top, clad with Ferrari fabric membrane offering 15% transparency.

While providing ample shade and rain shelter for plaza visitors, the solution maximizes the use of the existing structure and minimizes the weight of the new addition. The overhang is limited to within 2 meters of the kiosk's main body, creating an intimate resting space with a strong sense of place.

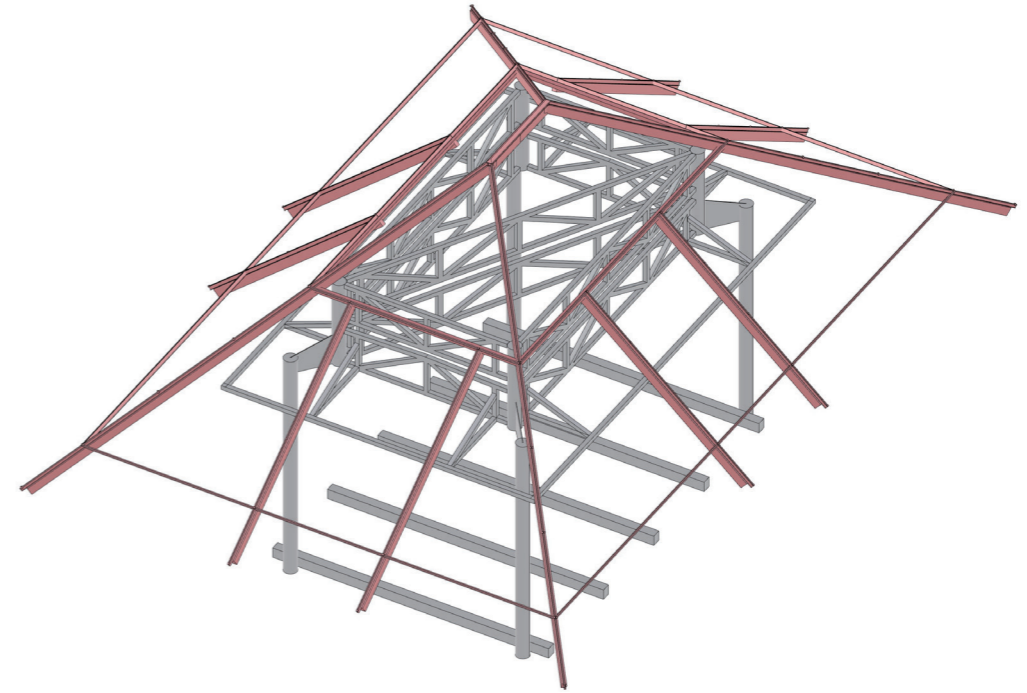

Brazilian Pavilion Expo Dubai 2020 / MMBB Arquitetos + Ben-Avid + JPG.ARQ











